

IMPORTANT INFORMATION - FOLLOW ALL INSTRUCTIONS

5GV-UNL 21Gv ORVR NOZZLE SPOUT REPLACEMENT

21Gv
ORVR NOZZLE

WITH **ACCUFLO**
TECHNOLOGY



IMPORTANT!

Please read all warnings and follow the installation instructions completely and carefully. Failure to do so will void all warranties and may cause product failure, or result in environmental contamination due to liquid leakage into the soil, creating hazardous spill conditions.

The following instructions define the proper field repair of the 21Gv ORVR nozzle spout and bellows.

INSTALLATION:

- 1) Clamp the nozzle in a vise or other suitable holding device. (Figure 1)
- 2) Remove the lower clamp from the old vapor boot and discard the clamp. (Figures 2 & 3)
- 3) By pulling the bellows assembly over the old spout, the internal spring will automatically pop out of its groove. Once free, discard the old vapor boot/spring assembly. (Figure 4)
- 4) Remove the spout retaining screw (Figure 5) and pull the spout assembly out of the nozzle with a twisting motion. Throw the old spout assembly away, including the old screw.
- 5) Clean the bore of the nozzle and remove any foreign material. (Figure 6)

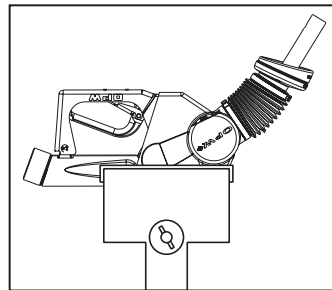

FIGURE 1

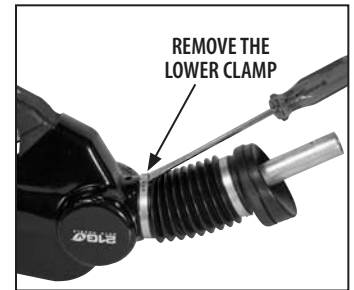

FIGURE 2

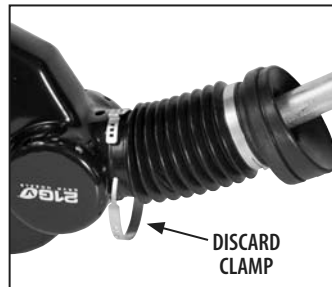

FIGURE 3

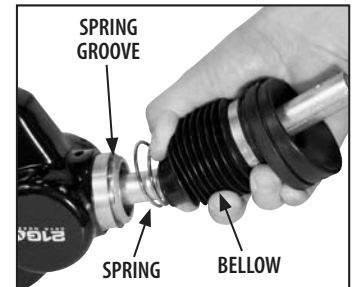

FIGURE 4

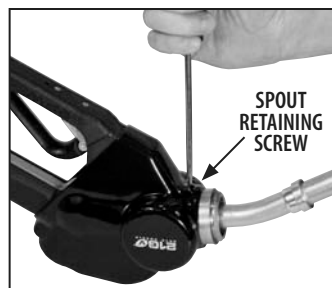

FIGURE 5



FIGURE 6

- 6) Install new O-rings (supplied) on spout (*Figure 7*) and coat the O-rings with petroleum jelly.
NOTE: There are two different size O-rings – one large and one small.
- 7) With a gentle twisting motion, insert the new spout assembly into the outlet end of the nozzle such that the retaining screw hole on the nozzle body matches the hole on the spout (*Figure 8*). If the retaining screw holes on the nozzle body do not match the holes with the spout, twist the spout slightly so that the holes align with each other.
- 8) Install the new retaining screw into the spout. To prevent stripping, DO NOT over-tighten the screw. (*Figure 9*)
- 9) Place a new clamp (included in the kit) onto the new vapor boot assembly. (*Figure 10*)
- 10) Hold back the bellows so that the internal spring is exposed (*Figure 11*). Guide the assembly over the spout and snap the spring into the spring groove on the nozzle body. Then thread the spring in the direction shown in (*Figure 12*). Once the spring is fully engaged, release the bellows and guide it onto the nozzle body. Hold the nozzle by the handle and rotate the boot in the direction shown in (*Figure 12*) so the engraved lettering “OPW” on the cap and face seal are on the top and centered with the spout. (*Figure 13*)
- 11) Once the bellows is in proper position, rotate the clamp so the crimp is located on the bottom of the nozzle. Lastly, crimp the clamp firmly using a crimping tool. (*Figure 14*)

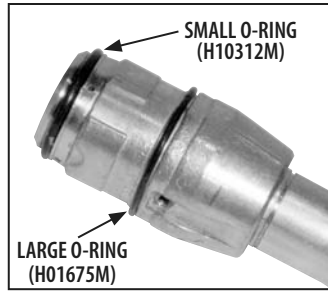

FIGURE 7

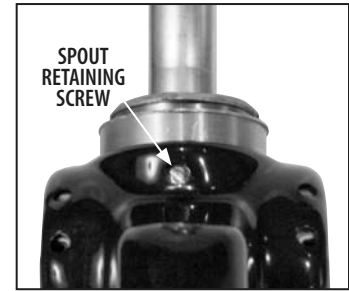

FIGURE 8

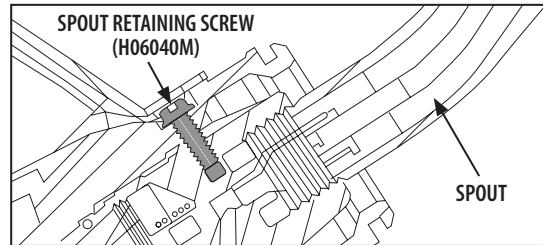

FIGURE 9

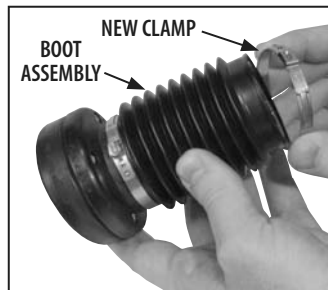

FIGURE 10

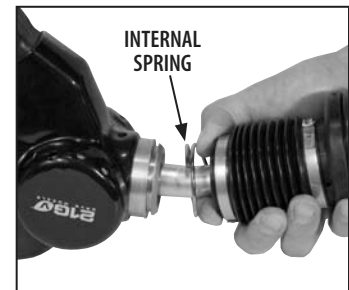

FIGURE 11



FIGURE 12

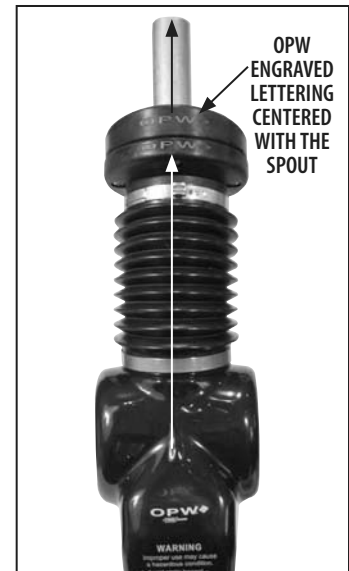

FIGURE 13

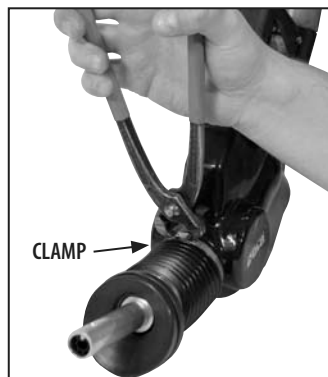

FIGURE 14

SHUT-OFF TEST

- 1) Make sure approved test container is placed directly on a grounded surface.
- 2) Start flow into approved test container; place nozzle in low clip position.
- 3) Immerse nozzle spout tip into gasoline within the approved test container. The nozzle tip must be at least three (3) inches from the bottom of the container to prevent back-pressure in the spout. (*Figure 15*)
- 4) Nozzle must shut-off immediately.
- 5) Repeat procedure for all clip positions. Nozzle must always shut-off in all clip positions.
- 6) Test each nozzle a minimum of five (5) times in each clip position. (*Figure 16*)
- 7) For models without hold-open racks, test at full open position only
- 8) If no shut-off occurs, recheck to ensure flow rate is greater than 3GPM. A flow rate below this level will not allow the automatic shut-off feature to operate properly. If flow rate is above 3GPM and there is no shut-off, replace nozzle.

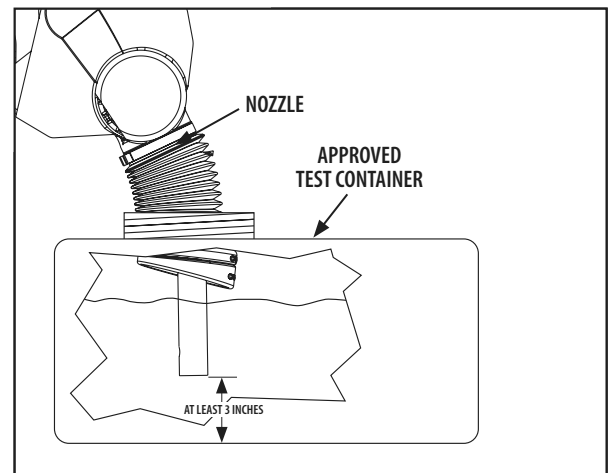

FIGURE 15

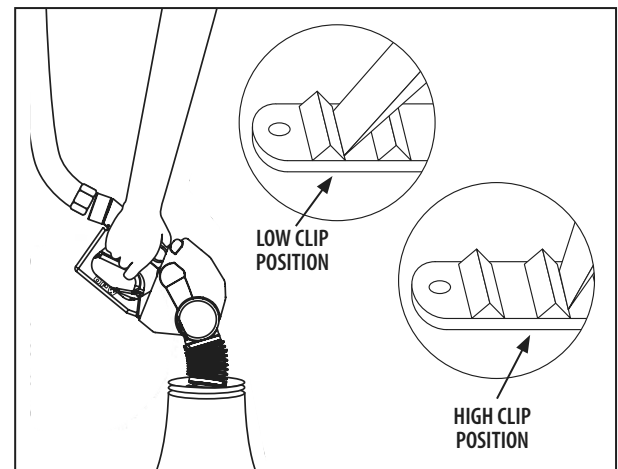

FIGURE 16

OTHER TEST(S):

- 1) Perform other test(s) as required by authorities having jurisdiction.

See OPW's website at www.opw-fc.com or contact an OPW Distributor for troubleshooting guides and/or how to use the OPW nozzle.

WARNING!

FIRE HAZARD/SPILL HAZARD/CHEMICAL EXPOSURE. REPLACE THE NOZZLE IF THE NOZZLE FAILS ANY OF THE TESTS. FAILURE TO COMPLY COULD RESULT IN PROPERTY DAMAGE, INJURY, OR DEATH.



OPW STANDARD PRODUCT WARRANTIES

NOTICE: FlexWorks by OPW, Inc., VAPORSAVER™ and all other OPW products must be used in compliance with all applicable federal, state, provincial and local laws, rules and regulations. Product selection must be based on physical specifications and limitations, compatibility with the environment and material to be handled. All illustrations and specifications in this literature are based on the latest production information available at the time of publication. Prices, materials and specifications are subject to change at any time, and models may be discontinued at any time, in either case, without notice or obligation.

OPW warrants solely to its customer that the following products sold by OPW will be free from defects in materials and workmanship under normal use and conditions for the periods indicated:

Product	Warranty Period
FlexWorks Primary Pipe	10 years from date of manufacture
All Products Certified to California 2001 Standards*	1 year from date of manufacture or from date of installation registration (not to exceed 15 months from date of manufacture)
All other Products	1 year from date of manufacture
* Products certified to California 2001 Standards will have an OPW registration card enclosed/attached to the product.	

OPW's exclusive obligation under this limited warranty is, at its option, to repair, replace or issue credit (in an amount not to exceed the list price for any defective product) for future orders for any product that may prove defective within the applicable warranty period (repairs or replacements are subject to prorated warranty coverage for remainder of the original warranty period). Complete and proper warranty claim documentation and proof of purchase required. All warranty claims must be made in writing and delivered during the applicable warranty period to OPW at P.O. Box 405003, Cincinnati, Ohio 45240, Attention: Customer Service Manager. No products may be returned to OPW without its prior written authority.

This limited warranty shall not apply to any FlexWorks or VAPORSAVER™ product unless it is installed by an OPW attested installer. This limited warranty also shall not apply to any FlexWorks, VAPORSAVER™ or other OPW product: unless all required site and warranty registration forms are completed and received by OPW within 60 days of installation; unless all piping connections are installed with a nationally-recognized or state-approved leak detection device in each tank and dispenser sump (which are not for storage and from which all discharge hydrocarbons must be removed, and the systems completely cleaned, within 24 hours); unless testable sumps utilize FlexWorks pipe and access fittings; unless a sump inspection log or an EPA recommended/required checklist is maintained and the results are furnished to OPW upon request; and unless OPW is notified within 24 hours of any known or suspected product failure and is provided with unrestricted access to the product and the site. This limited warranty also shall not apply to any product which has been altered in any way, which has been repaired by anyone other than a service representative authorized by OPW, or when failure or defect is due to: improper installation or maintenance (including, without limitation, failure to follow FlexWorks Quick Reference Manual Installation Guide and all product warning labels); abuse or misuse; violation of health or safety requirements; use of another manufacturer's, or otherwise unauthorized, substances or components; soil or other surface or subsurface conditions; or fire, flood, storm, lightning, earthquake, accident or any other conditions, events or circumstances beyond OPW's control.

THIS LIMITED WARRANTY IS IN LIEU OF ALL OTHER WARRANTIES, EXPRESS OR IMPLIED, AND ALL OTHER WARRANTIES INCLUDING, WITHOUT LIMITATION, THE WARRANTIES OF MERCHANTABILITY AND FITNESS FOR A PARTICULAR PURPOSE, ARE HEREBY EXCLUDED. OPW shall have no other liability whatsoever, whether based on breach of contract, negligence, gross negligence, strict liability or any other claim, including, without limitation, for special, incidental, consequential or exemplary damages or for the cost of labor, freight, excavation, clean-up, downtime, removal, reinstallation, loss of profit, or any other cost or charges. No person or entity is authorized to assume on behalf of OPW any liability beyond this limited warranty. This limited warranty is not assignable.